



Campus Backpack Parent Access

-New User-

Parents have the option to create accounts in Infinite Campus, which will allow access to your student's report card as well as other school related information.

1. Visit www.Spencerportschools.org and click Infinite Campus Portal. Select **Campus Parent**.

2. To create a new account, select **New User?**

3. You will be prompted to enter your activation code, which is located on the enclosed Infinite Campus Letter. Use this code to start the account creation process.

4. Once you have registered, you'll be taken to the Campus Parent Portal log on screen. Sign in with the username and password that you created.

5. To view your student(s) report cards, click **More** then **Campus Backpack**. You will be taken to another screen. You can view the report card(s) by clicking the icon under **View**.

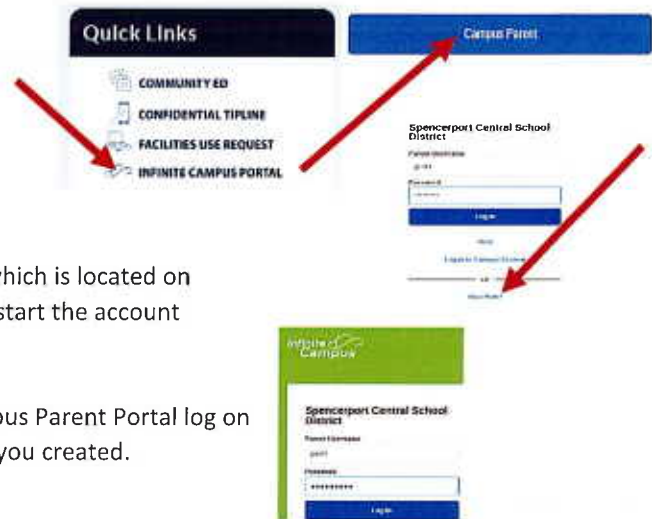

Student Name	Document Name	Published Date	Acknowledged	View
Lyell Port	Taylor Elementary Q1 Mockup	Oct 3, 2019 10:24 AM	Port Jane	>
Ranger Port	Taylor Elementary Q1 Mockup	Oct 3, 2019 10:24 AM	No	>

Reports on this page require the Adobe Acrobat Reader (free).



6. Lastly, you will see a prompt on the top of the screen which states "Please check this box to acknowledge this document and then click Save." Click the check box then **Save**. Click **OK**.



For any questions, please contact one of the Infinite Campus Coordinators.

Elementary: Charles Ocasio – 585-349-5152

Middle School: Linda Sauter – 585-349-5324

High School: Lori McSorley – 585-349-5247